

285.00 mm

420.00 mm



# LEFEET C1 WATERSCOOTER

User manual



## WHAT'S IN THE BOX

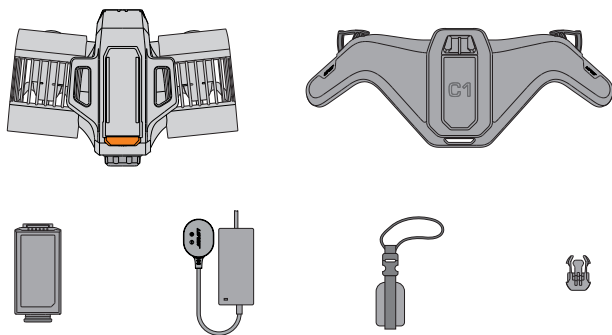

## PRODUCT DIAGRAM

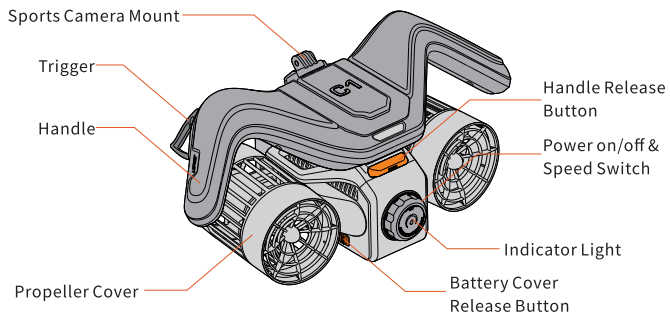

1

## CHARGING

1. Connect the plug(A) of the battery charger to the AC power source (100V-240V; Use a power adapter plug if necessary).
2. Align and insert the charger head(B) of the battery charger into the battery charging port, and fully press down.
- 3.The indicator light on the charger will turn red, indicating that the battery is being charged. When it turns green, it means that the battery is fully charged. It takes about 2 hours to fully charge the battery.

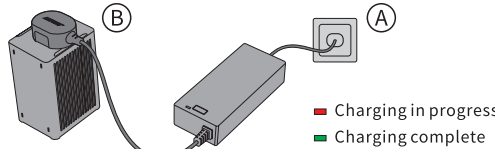

## INSTALL THE BATTERY

1. Slide the orange buttons on both sides backward and lift up to open the battery cover.
2. Install the battery with the battery label facing up, making sure that the latch at the back of the battery snaps onto the orange lever. (If the battery is not installed properly, the battery cover can not be snapped into place.)
3. Press the battery cover downwards until both orange buttons on the sides are back in their original position and you hear a "click" sound to ensure that the battery cover is securely closed.

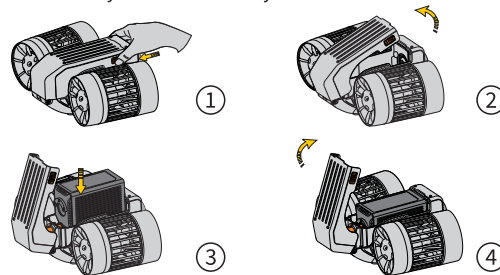

- \* To remove the battery, simply perform the steps in reverse.
- \* Never submerge the device in water without installing the battery!

2

## INSTALL AND REMOVE THE CONTROL HANDLE

Align the control handle slot with the top rail of the main unit, slide it back until you hear a "click" sound to install it in place.

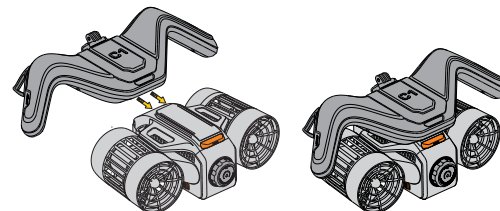

To remove the handle, press the orange button located between the main unit and the control handle, and slide the control handle out in the opposite direction.

## POWER ON AND OFF, AND SWITCH SPEED LEVELS

Power on, power off, and switch between speed levels by rotating the knob. Power on or off: Rotate the main knob clockwise to the end and hold for 2 seconds. Release it after hearing the prompt sound to complete the power on or off operation.

Switching speed levels: Rotate the main knob clockwise to the end and quickly release it to switch to a different speed level. One light indicates low speed (1.3m/s), and two lights indicate high speed (1.6m/s).



- \*The speed test result is based on calm water testing, the actual speed may vary depending on the usage environment and user, which is considered normal.
- \*When the battery level is low, the speed level will automatically reduce to low speed and cannot be switched to high speed.
- \*The device will automatically shut down if there is no operation over 15 minutes.

3

## CHECK BATTERY LEVEL

Rocket-shaped indicator on the main unit indicates the battery level:

- Green light: battery level is approximately 60%-100%
- Yellow light: battery level is approximately 20%-60%
- Red light: battery level is below 20%



## STARTING THE SCOOTER

Hold the handle of the control handle, and simultaneously press the left and right orange triggers to start the scooter. Release any trigger the scooter will stop.

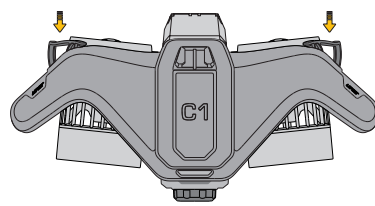

\*This product is designed for use in water. Please do not start the propeller in the air.

4

## MAINTENANCE

To maintain the good performance of this product, please do the following maintenance after each use:

1. Immerse the product in a container filled with fresh water for about 30 mins.
2. Hold the Handles with both hands and run it at low speed for one minute while the product is completely immersed, and repeat 2-3 times.
3. Wipe the product with a soft, clean, dry cloth.
4. Wipe off the water droplets around the battery compartment. Open the battery cover with dry hands and remove the battery.
5. Place the Main Unit and battery in a cool, ventilated place to dry completely.

## STORAGE

- Do not store the product in environments with high or low temperatures, excessive dryness or humidity, direct sunlight, or dusty conditions, as harsh environments can damage electronic devices.
- Before storing the product, please charge the battery to about 60% to prevent over-discharge of the battery due to long-term idle.
- If not used for a long time, charge the battery to about 60% once every three months.
- The storage temperature should not exceed the range of -10°C to 50°C.
- If water enters the positive and negative poles of the battery, please place the battery in a safe place, do not charge it, and contact the distributor.

## DISPOSAL AT END-OF-LIFE

This product must not be disposed of by incineration, land filling, or chemical risks to the environment.

The recommended disposal for any LEFEET C1 at its end-of-life is to dispose of the entire unit at or through an e-waste recycling center, program, or facility.

Local regulations and laws pertaining to the recycling and disposal of lithium-ion batteries and/or products containing them will vary according to country, state, and local governments. You must check laws and regulations corresponding to where you live in order to properly dispose of the battery and/or unit. It is the user's responsibility to dispose of their waste equipment properly with accordance with local regulations and laws.

For additional information about where you should drop off your batteries and electrical or electronic waste, please contact your local or regional waste-management office, your household waste disposal service, or your point-of-sale.

5

## LEFEET C1 SPECIFICATIONS

Main Unit	Net Weight	~3kg (Including Battery)
	Dimensions	406*207*171 mm
	Work Temperature	0°C~40°C
	Waterproof Depth	30 m
	Speed Settings	Low/High
Battery	Battery Runtime	30-60 mins
	Maximum Thrust	8 kgf
	Charging Voltage	25.2 V
	Charging Current	3 A
	Rated Capacity	4500 mAh
Charger	Rated Energy	97.2 Wh
	Charging Temperature	0°C~40°C
	Charging Time	~2 h
	Net Weight	~800 g
	Input Voltage	100 ~ 240 V
Charger	Output Voltage	25.2 V
	Output Current	3 A

\*As the battery is consumed, the power will gradually weaken, and automatic speed reduction and speed level jumping may occur, or the high-speed level may not be available for use. This situation is considered normal.

\*This data is for reference only. The actual duration of use will vary depending on different speed level, user weight, usage environment, etc.

### SAFETY WARNINGS

LEFEET C1 is designed with user safety as the top priority. However, like any electronic sports product, using C1 also carries certain risks (such as losing control). Therefore, it is very important to read and follow all instructions and warnings in the user manual and make good judgments when using it.

We consider the use of LEFEET C1 products as the user's acknowledgment and acceptance of all related risks and responsibilities that may arise during use, including but not limited to muscle injuries, fractures, tears, or other serious injuries. The use of LEFEET C1 is at your own risk. We are not responsible for accidents caused by a lack of common sense.

Children under 14 years old can only use it under the supervision of parents or other adults. For better safety, please read and follow all instructions and warnings in the user manual.

### WARRANTY SERVICE

**Main Unit:** LEFEET guarantees that the LEFEET C1 products you purchase are designed and manufactured according to the qualified standards. Under normal use, there is no functional defect during the warranty period. If you have any problem in the process of using, we recommend that you first check the user manual, furthermore, you can also download the user manual, FAQ, instructional video or support forum on our website.

**Scope of Services:** Your LEFEET C1 includes a one-year limited hardware warranty which starts from the date of the sales invoice, the warranty period of the main body is 12 months while the warranty period of the battery is 6 months. If you cannot provide invoice or other valid proof of purchase, then the warranty period will start from 90 days after the production date that shows on the product, or otherwise specified by LEFEET. If repairs are not feasible or commercially unfeasible, we may replace this product with new or refurbished products with similar

6

More ways to use your LEFEET C1 can be found at [www.lefeet.com](http://www.lefeet.com)

7





查看电量

4

Technical drawings of the C1 robot components, including the main body, wheels, and sensors.

Diagram illustrating the components of the 3-axis digital level:

- 运动相机底座 (Motion camera base)
- 动力扳机 (Power trigger)
- 手柄 (Handle)
- 手柄安装推钮 (Handle mounting button)
- 主机旋钮 (Main unit knob)
- 速度及电量指示灯 (Speed and battery level indicator)
- 电池仓盖推钮 (Battery compartment cover button)
- 桨罩盖 (Propeller guard cover)

## 维护

### ■ 存放

## 设备处理

5

1. 将电池充电器的插头端连接到交流电源 (100V-240V)；如有需要，请使用电源转换插头。
2. 将电池充电器充头与电池放电插口对齐插上，并完全压紧。
3. 充电器指示灯亮红色，表示电池正在充电，亮绿色表示电池已充满。充满电约需 2 小时。

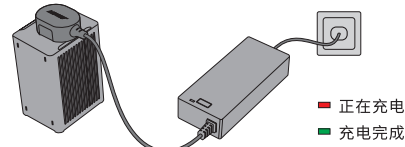

- 1.同时向后拨动橙色推钮，并向上抬起打开电池盖。
- 2.将电池标签朝上装入电池，注意电池后部的卡扣要卡住橙色推杆。(如未安装到位，电池盖将无法扣合。)
- 3.将电池盖向下按压至双侧橙色推钮恢复原位并听到“咔哒”的声音以确保电池盖扣合稳妥。

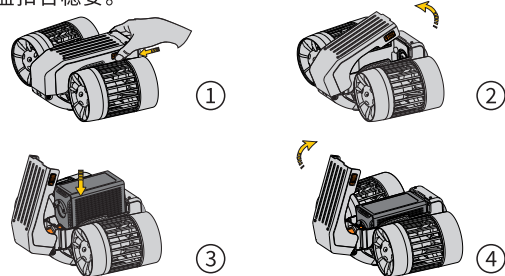

2

主机	重量	~3 kg(含电池)	充电电压	25.2 V
	尺寸	406*207*171 mm	充电电流	3 A
	工作温度	0℃~40℃	额定容量	4500 mAh
	防水深度	30 m	额定能量	97.2 Wh
	速度档位	二档：高速档/低速档	充电温度	0℃~40℃
	续航时间	30~60 mins	充电时长	~2 h
	最大推力	8 kgf	重量	~800 g
充电器			输入电压	100~240 V
			输出电压	25.2 V
			输出电流	3 A

充电器	输出电压	25.2 V
	输出电流	3 A

## 安全警示

LEFREET C1P 产品的安全使用。然而对于电子产品产生产品缺陷，产品的使用是否有一定的风险(如：火灾)，因此阅读和遵守《使用说明书》中的所有指示和警告，并在使用时确保良好的使用也是非常必要的。我们将使 LEFREET C1P 产品的行为视为用户承认并接受使用时所产生的所有相关风险和责任，这些风险包括但不限于手机损坏、骨折、撕裂或其它严重伤害。而使 LEFREET C1P 自行承担责任。由于缺乏常识而发生的意外事故，一概概不负责。

14岁以下的儿童在家长或其他成人监护的情况下可以使用。

为了更好地确保您的安全，请阅读并遵循《使用说明书》中的所有指示和警告。

### 责任限制

对于以下情况,无论本文规定的任何救济是否达到其根本目的,也不论索赔是基于合同、担保、疏忽、严格责任或其它责任理论,LEFEET 南非创新及其关联企业、供应商、经销商或服务供应商概不负责:

2) 特别的、附带的、间接的或继发的损害,包括但不限于利润、业务收入、商誉或预期可节省金额等方面的损失。无论损害基于任何原因,LEEFET 朗非创新及其关联企业、供应商、经销商或服务供应商的全部责任仅限于您实际遭受的直接损失,并且不高于您购买产品付出的金额。

将控制手柄滑槽对准主机顶部轨道, 向后滑入直到听到“咔哒”声安装到位。

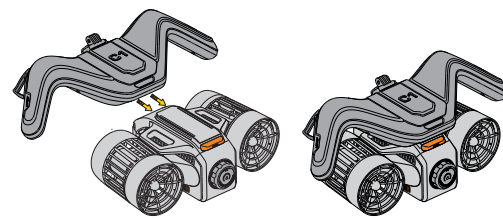

如要取出手柄,用手按住主机和控制手柄之间的橙色推钮,反向推出控制手柄。

通过旋转主机旋钮进行开机关机及切换速度档位。  
 开机或关机: 顺时针旋转主机旋钮到底并保持2秒钟, 听到提示声后松手, 完成开机或关机的操作。  
 切换速度档位: 顺时针旋转主机旋钮到底并迅速松手进行切换档位, 一颗灯表示1档 (1.3m/s)\*, 两颗灯表示2档 (1.6m/s)\*。

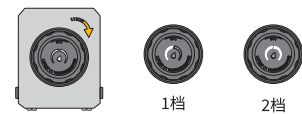

- \*该速度测试结果为平静水域测试,实际速度与使用环境和使用者的差距存在不同,视为正常情况。
- \*当电池电量低时,速度档位将自动降为1档并且无法切换到2档。
- \*主机15分钟没有任何操作时会自动关机。

**保修服务：**

尊敬的客户,LEFEET 朗非创新保证,您购买的 LEFEET C1 产品均按照合格的标准进行设计和制造,在正常使用情况下,在保修期内没有功能缺陷。如果您在使用产品的过程中遇到任何困难,建议您先查阅产品的用户手册,您也可以在我们的网站上下载到用户手册、常见问题解答、教学视频或支持论坛。

### 服务范围

您的 LEFREET C1 包含为期一年的硬件保修服务。本产品的保修期从销售发票开具当日算起；主机保修期限为 12 个月，主机电池保修期限为 6 个月。若您无法提供购买发票等有效证明，则保修起始日期以机器所示的生产日期向后顺延 90 个自然日或由 LEFREET 朗非朗重新另行规定。

如果维修不可行或者商业上不可行，我们可能会使用具有类似功能的新产品或者翻新产品来替换此产品。在维修固件升级或者更换后，更换的产品或配件在原产品剩余的保修期内享有同等的保修服务。

### 如何获得售后服务

在保修期间,若产品不能实现所保证的功能,请联系客服邮箱:service@lefeet.com 以获取相应的售后服务。LEFEET 朗非创新可能在某些地区不提供售后服务,且售后服务政策的内容也可能因地而异。常规服务范围外的服务可能需要另行收费。如欲了解本地信息,请联系 LEFEET 朗非创新客服。

### 获得售后服务的准备工作

联系 LEFEET 朗非创新后, 请您详细说明产品存在的问题。  
LEFEET 朗非创新技术支持人员将尝试通过电话、电子邮件或远程协助来诊断和解决您的问题。如果通过电话无法解决您的问题, 您需将产品寄回 LEFEET 朗非创新进行进一步检测。LEFEET 朗非创新会按产品享有的保修服务安排维修。

## 更换产品和部件

如果维修服务涉及更换产品或部件,那么被更换的产品或部件将成为 LEFEEET 朗非创新的财产,而更换的产品或部件将成为客户的财产。只有未经改动的 LEFEEET C1 和部件方可进行更换。LEFEEET 朗非创新提供的更换产品或部件可能不是全新的,但它们肯定处于良好的工作状态,至少在性能上与被更换件等同。更换的产品或配件在原产品剩余的保修期内享有同等的保修服务。

## 个人联系信息的使用

如果您根据本保修条款获取服务,即表示您授权 LEFREET 朗非创新存储、使用和处理您的联系信息,包括姓名、电话号码、地址和电子邮件地址等。

LEFREET 朗非创新可利用这些信息开展本政策项下的服务,我们可能会联系您,询问您对我们的保修服务是否满意,或就任何产品召回或安全问题向您发出通知。为实现上述目标,您授权 LEFREET 朗非创新将您的信息转移到我们开展业务的任何国家或地区,并可以将其提供给我们的代表机构。如果法律要求,我们也可以披露这些信息。

### 非售后政策保障范围

本政策不适用于或者不适用以下情况:

- 发生人为的非产品本身质量问题导致的故障、烧毁等;
- 发生有充分说明理由的自取、篡改、非正常方式而造成的损坏;
- 未按照说明中的正确安装、使用、维护、保养;
- 没有充分说明理由的情况下,客户自行修改或者未经官方授权的服务机构维修/修改软件造成的损坏;
- 因非官方说明书指导的错误改造造成损坏,电源的乱配使用不当导致的损坏;
- 因产品或者在符合产品用户手册中环境下造成的产品故障;
- 由于未经授权用户私自对产品进行改造、加设设备或者附件造成的损坏;
- 在电源不正常使用或者在不符合电源使用环境条件下使用造成的损坏,如:潮湿、强磁、强电、静电、电压、电流、电压、电流、火灾、自然灾害、运输造成的损坏;
- 产品损坏与识别标签的产品编号或者产品型号、序列号、或者生产日期已淡去、去除或者无法辨识;
- 改动设备在未经授权、制造或者批准使用的国家/地区使用而无法正常工作的。

可以通过[www.lefeet.com](http://www.lefeet.com)获得您购买的LEFEET C1的更多使用方式。

7